



INSTRUCTION MANUAL

High Performance Electric Reel **KAIGEN1000**

Thank you for purchasing a Banax electric reel.
Please read this manual completely prior to use.
Respect all safety and operating instructions provided in this manual.
Keep this manual with your reel for referencing operations.

CONTENTS

1. Safety Precautions ----- P1~4	6. Preparation for use * Power Supply Connections ---- P9	* Releasing the Fishing Line --- P18	* Resetting Counter Due to Line Breaks ----- P25
2. Care and Cleaning ----- P5	* Specifying Line Diameter & Spooling Instructions ---- P10~13	* Winding Operation & Feature Controls ----- P19	8. Understanding Safety Feature ----- P26~27
3. Main Function & Features ---- P6	7. Operating Instructions * Auto Stop Setup ----- P14~15	* Hi Speed Function ----- P20	9. Troubleshooting Faults ----- P28
4. Part Identification and Functionality ----- P7	* Setting the Secondary Stop Depth ----- P16~17	* Targeted Depth mode ---- P21~22	10. Parts List & Breakdown --- P29~30
5. Display and Control Functions --- P8		* Bottom mode ----- P23~24	

SAFETY WARNINGS

READ BEFORE FIRST USE!

Warning



- Keep fingers away from the level wind area at all times. Severe injury may occur. Disconnect power prior to working in the area of the level wind.

Injury Avoidance



- Do not touch the fishing line while deploying or retrieving line. Severe injuries may occur.
- Do not use the reel for any activity other than fishing.
- The reel comes lubricated, ensure that clothing / upholstery is not stained by excess lubrication



- Do not touch any moving part of the reel during operation, doing so may cause severe injuries.
- Always ensure that the speed control is set to "off" prior to powering the reel. Remove power if reel runs when speed control lever is set to "off".



- Do not disassemble or modify the reel, damage may occur



- Only to be used on 12 Volt DC based systems. Running on any other voltage will damage the reel and may cause injury.



- Do not submerge or direct spray at the reel, only wash with a damp towel

1

SAFETY WARNINGS

1 Power Supply Requirements & Recommendations

This reel is designed for use on 12 VDC systems only

- Low battery capacity less than 5000mAh, may cause a drop in voltage, creating a risk of reel damage. Use a battery with a higher capacity than 5000 mAh
- Do not use a power supply to power the reel, only use battery power sources. Unstable power sources will cause the reel to trip, ceasing operation.
- Always use a fully charged battery. Batteries in storage may discharge, always ensure the batteries used are fully charged prior to use.
- Low voltage is frequently caused by corrosion. Always ensure all contact and terminals are clean and free of corrosion if a low / no voltage condition exists.



DC 12V
(5000mAh)



AC 110V, 220V



DC 24V



Please check below list before leaving



- Before connection to a vessel battery, ensure the vessel uses a 12VDC system. Not all vessels are 12VDC and may damage the reel. Ensure polarity is correct as well, otherwise the reel will may be damaged.

SAFETY WARNINGS

2 Power Supply Cord

- Only use the power cord supplied with the reel, use of other cords may damage the reel.
- Handle the power cord with care. Impacts, kinks/bends, cuts may damage the cord. Contact your retailer for replacement power cords.
- Do not submerge the power cord, clean with a damp towel, and dry promptly
- Remove the plug by grasping the male connector, do not pull on the cable.

3 Operational Handling

- If the line is caught on an obstruction or very large fish, do not use the reel to free the line. Either cut the line or find other means to retrieve the line.
- Handle carefully, do not drop!
- When using a rod holder ensure that the power cord is not bent or kinked. Make sure the power cord does not impact the rod holder or structure around it.

2

Cleaning & Care

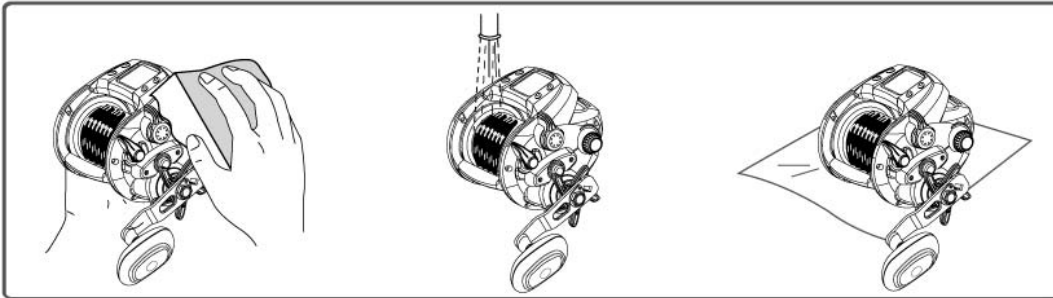

1 Clean all areas of the reel with a damp cloth

2 Gently rinse contamination, salt, and any soap with a gentle spray of water. Ensure that the line is well rinsed to prevent corrosion.

3 Thoroughly dry the reel, and place in a low humidity environment to dry.

! Warning!

- Only use gentle, neutral detergents. Harsh chemicals will deteriorate the finish of the reel, and may damage internal components as well.
- Do not direct strong spray into the reel, and do not submerge the reel.
- Store the reel in a dry area, with low humidity to prevent corrosion during storage.
- Do not add lubricants to the drag surfaces, this may cause the reel to perform improperly.
- Always replace the cover to the power receptacle when not in use.

Main functions and features

Speed Lever	Controls winding speed of the reel
Star Drag	Powerful, smooth, and durable carbon drag washers
Jigging Function	Rapidly reels the line for jigging action
Auto Stop	Automatically stops the reel to prevent equipment damage
High Speed	Rapidly retrieves the line, maximizing your time on the water
Water Surface Adjustment	Sets the offset between the rod tip and the water, allowing precise depth placement.
Motor Assisted Release	Motor helps to control the rate of deployment, helping to avoid tangles and bird nests
Targeted Depth Alarm	Notifies the user when a preset depth is achieved when releasing line, allowing rapid return to the correct depth.
Targeted Depth Memory	Marks the depth where fish are being caught, creating an easy reference when releasing the line.
Bottom Mode	Used to measure the distance from the bottom of the seafloor
Line Reset	Easily reset the line counter when changing tackle or line breakage.

Part Identification & Functionality

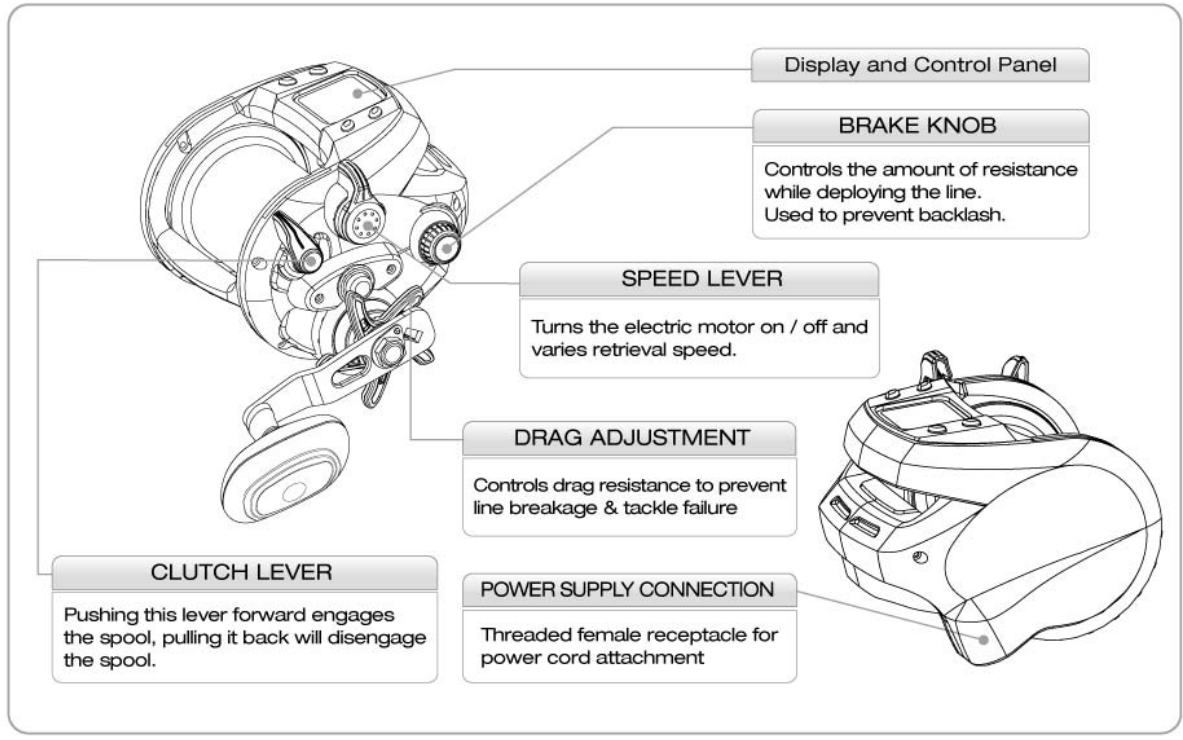

Display and Control Panel Functions

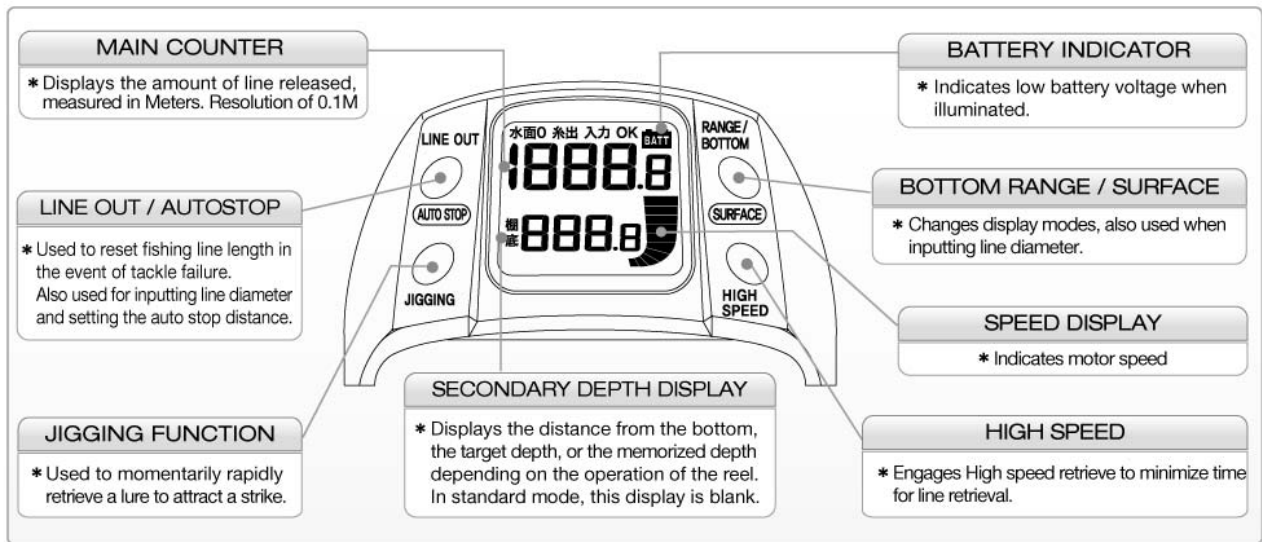

! WARNING!

- The display is designed for use between -10C to 60C. Temperatures outside of this range may make the display difficult to read.

6

Preparation for use

Connecting to a power supply

- Connect the power cord to the battery, observing polarity.
Red clamp is positive (+)
Black clamp is negative (-)
- Insert the male end of the power cord firmly into the receptacle on the reel.
There is a slot molded into the receptacle to ensure proper orientation, DO NOT FORCE. Thread the locking collar onto reel.
- The reel will sound a series of beeps indicating the power is connected.
 - If the line diameter has not been setup, Picture 3 will show on the display.
 - If the line diameter has been set, the screen should appear like Picture 4.
 - The battery symbol in the top right corner of the display will disappear within a few seconds, if not, please check the condition of the battery or the connections.
 - If the battery is disconnected during operation, the reel has approximately 10 minutes to be reconnected before losing memory.
 - The default auto stop depth is 5 meters.
Electric winding will not work at less than 5M of depth when using the speed lever.

Picture 1



Picture 2



Picture 3



Picture 4



Blinking, Then off



Warning!

- If the reel is disconnected, do not reel or release line.
This could cause personal injury or damage to the reel.

Preparation for use

Automatic Spooling Method

* The reel has 4 preset braided line choices

PE6-1000m PE8-800m PE10-600m PE12-500m

- ❶ Thread line through level wind and attach to spool.
Disconnect power when doing this, otherwise injury may occur.
- ❷ The LCD display should appear as shown in Picture 5, unless line data has already been entered.
Following the next steps will reset the reel to the newly entered line data.
- ❸ Press and hold the top 2 buttons simultaneously for approximately 3 seconds.
These are the "Line Out" and the "Range / Bottom" buttons.
The display should appear as shown in Picture 6.
- ❹ Pressing the "Line Out" button will cycle through the available presets as shown in Picture 7.

Picture 5



000.0
000.0

Picture 6



1000.0
-6-

Picture 7

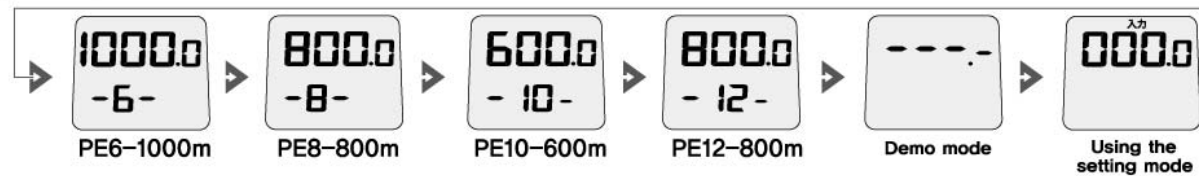

6

Preparation for use

- ⑤ Once the correct line diameter and length is displayed, use the speed control knob to start spooling the line onto the reel.
- ⑥ The motor will automatically stop 15M before the selected length. Manually reel in the last 15M of line.
- ⑦ Once the spooling is complete, press the “Range / Bottom” button and the reel will reboot. The display should follow the cycle shown in Picture 8.

Picture 8

- In the case of winding PE 8 line 800M.

798.5
8-8.0

Winding completion

Push
“Range/Bottom”

1888.8
888.8

Setting screen

0.0

The input is completed



Attention

- ① When spooling the reel for the first time it is very important to apply a steady 2 – 3 KG load on the line. This will prevent the braid from burying itself into the layers below. When spooling, it is best to run the speed lever at the maximum speed position. If the reel overheats during the spooling process, you are likely using too much resistance. Pull back the speed lever to zero, wait 5 minutes, and continue reeling in high speed.
- ② If you press the “Range /Bottom“ switch and select the demo mode, existing data will be erased and replaced by the demo mode.
- ③ If there are any errors during the spooling process, press the “Range /Bottom” switch and start the process over
- ④ Although the accuracy of the reel is under 3%, variances in depth display are possible if the line expands or contracts. Uneven spooling pressure will cause depth discrepancies as well.

Preparation for use

Manual input of line diameter and length

- Used to input a user determined length of line using preset diameters
 - * Selections for braid and monofilament lines are provided.
 - * The available line sizes for braid are: PE6, PE8, PE10, and PE12.
 - * The available line sizes for monofilament are Nylon 14/16/18/20
- ① Thread line through level wind and attach to spool.
Disconnect power when doing this, otherwise injury may occur.
- ② The LCD display should appear as shown in Picture 9, unless line data has already been entered.
Following the next steps will reset the reel to the newly entered line data.
- ③ Press and hold the top 2 buttons simultaneously for approximately 3 seconds.
These are the "Line Out" and the "Range / Bottom" buttons.
The display should appear as shown in Picture 10.
- ④ Press the "Line Out" button 5 times to select the setting mode.
The display should appear as shown in Picture 11.
- ⑤ Press the "Jigging" button to cycle through the selections shown in Picture 12, until you find the desired line diameter.

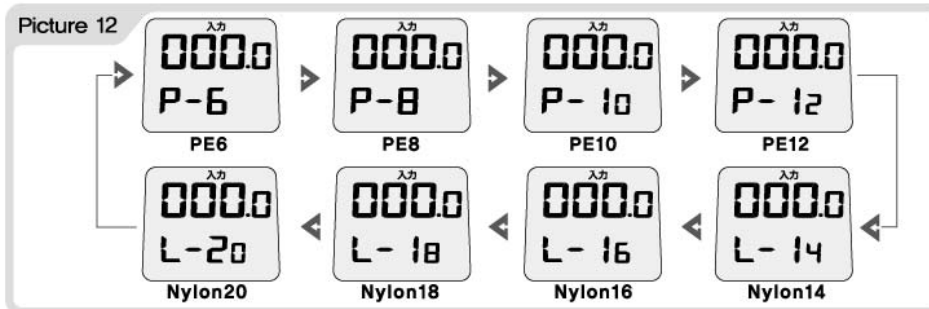
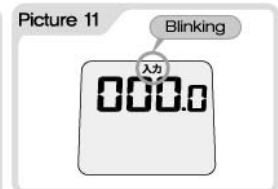
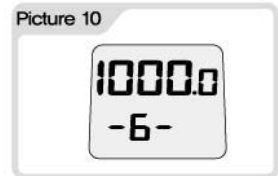
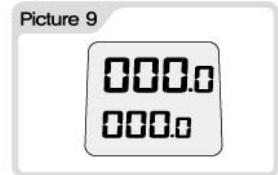

6

Preparation for use

- ⑥ Once the correct line diameter and length is displayed, use the speed control knob to start spooling the line onto the reel.
- ⑦ After winding on the desired length of line, press the “Range / Bottom” button to reset the reel.
The process is shown in Picture 13



! Attention

- ① When spooling the reel for the first time it is very important to apply a steady 2 – 3 KG load on the line. This will prevent the braid from burying itself into the layers below.
When spooling, it is best to run the speed lever at the maximum speed position.
If the reel overheats during the spooling process, you are likely using too much resistance.
Pull back the speed lever to zero, wait 5 minutes, and continue reeling in high speed.
- ② If you press the “Range /Bottom” switch and select the demo mode, existing data will be erased and replaced by the demo mode.
- ③ If there are any errors during the spooling process, press the “Range /Bottom” switch and start the process over
- ④ Although the accuracy of the reel is under 3%, variances in depth display are possible if the line expands or contracts. Uneven spooling pressure will cause depth discrepancies as well.
- ⑤ If any of the error messages are displayed on the screen as shown below, please return your reel to your authorized retailer for repair.

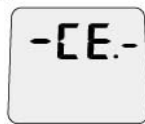

Control box error

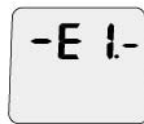

Short of the fishline



Spool rotation error

7

Operating Instructions

1 Auto Stop Setup

- The stop position can be adjusted depending on the tackle and fishing application.

Operation sequence ① : Connect the reel to a power supply, and set the line out to be at your desired stopping point.

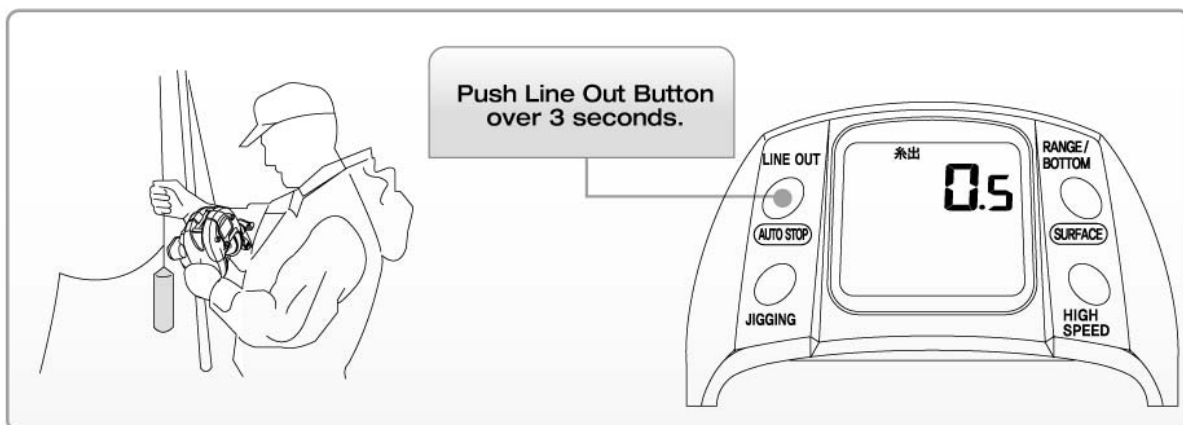

7

Operating Instructions

Operation sequence ② : Press the “Line Out / Autostop” button for at least 3 seconds.
The reel should beep, and the display should appear as shown in Picture 14.

* “OK” will appear at the top of the display, and will disappear after 5 seconds.

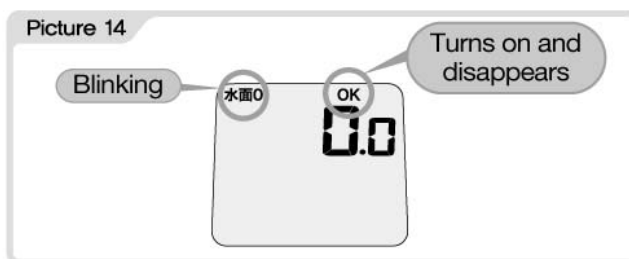

! Attention

- ❶ The Auto Stop feature default is 5M.
- ❷ Be aware that the fishing line may stretch or contract, causing variances in the auto stop distance, always pay attention to the reel when in operation.

Operating Instructions

2 Setting the water surface

- In order to ensure accurate depth measurement, set the offset of the water surface.

After setting the auto stop distance, the display should appear as shown in picture 15.

Picture 15

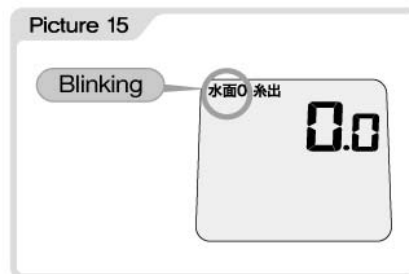

Operation sequence ① : Adjust your fishing tackle so that the tackle is located on the surface of the water, the display will show -0.0



7

Operating Instructions

Operation sequence ② : Press the “Range / Bottom / Surface” button momentarily.
“OK” will appear on the screen as shown in Picture 16.

* “OK” will disappear once 10M or more line is released.



Attention

- ① Water Surface is different from Auto Stop.
Water surface is only setup to ensure very accurate depth measurements.

Operating Instructions

3 Releasing the fishing line

- When releasing the line, you will hear the motor turn on, assisting with the line release.

Explanation of Operation

- ① Once the line depth exceeds 10M while releasing the fishing line, the motor will rotate automatically.
- ② If the spool rotation stops or backlashes during descent, the motor will stop to help prevent backlash.
- ③ If the line is released again, the motor will restart in the same direction.
- ④ If the targeted depth is set, the motor rotation will stop 5M before the set depth

Turning the line release assist on and off.

- Push the “Line Out / Autostop” button and the icon shown in Picture 18 will disappear, and the display should look as shown in Picture 17. This disables the feature.
- * To enable the feature, press the “Line Out / Autostop” button again, and the display should reflect what is shown in Picture 18.

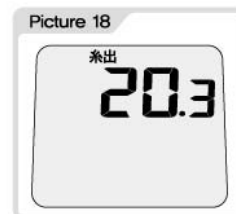
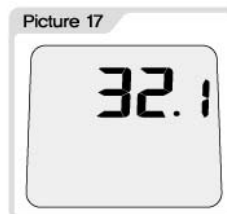

Attention

- ① Minor time lag can occur when stopping the reel, be aware of this.
If the clutch is engaged while the motor is running, a few Centimeters of line may be reeled up.

7

Operating Instructions

4 Automatic winding and speed control operation

- Motor operation and speed is controlled by the speed lever

Operation sequence ① : If the speed lever is not in the "Off" position, pull the speed lever to the rear and set at zero.

Operation sequence ② : The speed of the reel is controlled by this lever position.

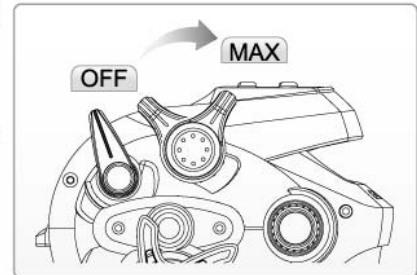

- * Pushing the speed lever forward increases the speed of the line retrieval.

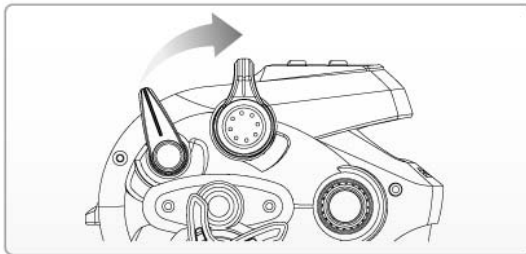

- * Pulling the lever towards the rear of the reel will slow down the winding speed.

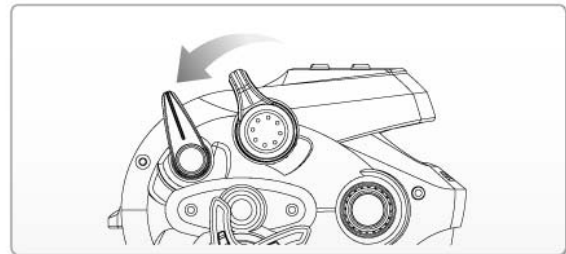

Attention

- ❶ Once the auto stop distance is reached, the speed lever will become inoperable and will not reel to prevent damage to tackle. The "Jigging" button will still retrieve the line if pressed.

Operating Instructions

5 High Speed

- This feature allows rapid retrieval of fishing tackle.

Operation Sequence ① : Press the “ High Speed” button once, and the reel will begin winding at high speed

Operation Sequence ② : Press the “ High Speed” button again, and the reel will stop winding

Picture 19



⑨ High Speed

* Motor operates at maximum speed.



Attention

- ① For your safety, the High Speed function will not operate with less than 10M of line out.
- ② If the speed lever is operated while the reel is in High Speed mode, the speed lever will take priority and regulate the speed.
- ③ If the reel is being operated by the speed lever, and the “High Speed” button is pressed, the reel will wind at high speed
- ④ Once 10.0M is reached, the reel will default to the speed set by the lever.

7 Operating Instructions

6 Targeted fishing depth setup

- This allows you to set a targeted depth, and quickly deploy lines to the desired depth

Operation sequence ① : Deploy the line to the desired depth and press the "Range / Bottom" button.

- * As seen in Picture 20, the targeted depth will show on the sub counter
- * When deploying the line, the reel will alarm at 5M from the targeted depth.

Picture 20

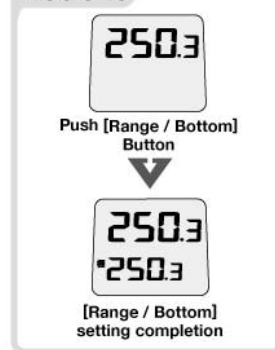

Recalling a targeted depth

- This is used to recall the depth of the line after a fish was caught.

Operation sequence ① : Reel up fish and tackle

- * If the line depth indicated is less than 10M, the targeted depth will be recalled in the sub display as shown in Picture 21.
(This depth is determined where the reel was last stationary for 5 seconds or more.)

Operation sequence ② : When the sub display shows the blinking depth shown in Picture 21, Press the "Range / Bottom" button. The reel should then appear as shown in Picture 22.

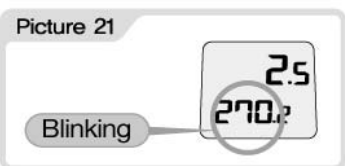

- * If the line is released beyond 10M without the "Range / Bottom" button being pressed, the display will return to normal. If a targeted depth is already preset, the reel will display this set depth.

Operating Instructions

Cancelling Targeted Depth Mode

- Press and hold the “Range / Bottom” button for more than 2 seconds. The mode will switch to bottom mode as shown in Picture 23.
 - * The targeted depth will be removed.
 - * To return to the targeted depth mode, press and hold the “Range / Bottom” button for more than 2 seconds.

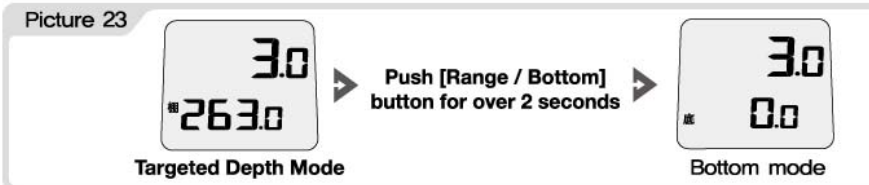

Attention

- ❶ Targeted depth mode cannot be set up to be less than 10M
- ❷ Targeted depth cannot be changed while the motor is running.

7

Operating Instructions

6 Bottom Mode

- This feature displays the depth relative to the bottom, essentially providing an inverse counter.

If the targeted depth mode is not in use

Operation sequence ① : Push [Range / Bottom] button, the reel should appear as shown in Picture 24

- * The icon to the left of the sub display will illuminate.
- * Ensure that more than 10M of line has been released.

Operation sequence ② : Press and hold the "Range / Bottom" button again, for more than 2 seconds.

- * 0.0 will be displayed on the sub display, setting the bottom point. See picture 25.

Picture 24



Picture 25

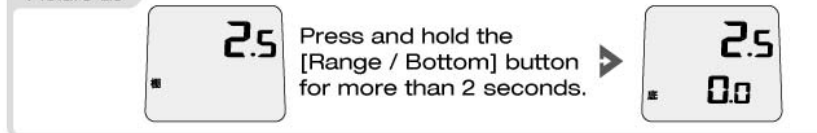

If the targeted depth mode is currently in use

Operation sequence ① : Press and hold the [Range / Bottom] button for more than 2 seconds.

- * The targeted range will reset to 0.0, indicating bottom mode as shown in Picture 26.

Picture 26

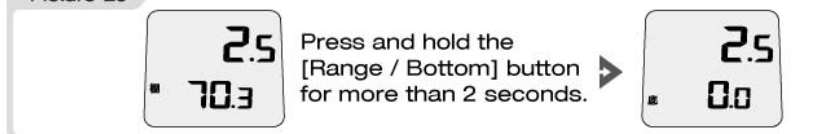

Operating Instructions

Bottom Mode Operation

Operation sequence ① : Resetting the bottom depth as conditions change

Operation sequence ② : Push “Range / Bottom” button, the reel should appear as shown in Picture 28, resetting the bottom depth to 0.0 in the sub display.



7

Operating Instructions

8 Correction of Fishing Line Length

- If your fishing line is severed, easily calibrate the reel to the new length
 - * This operation only applies to PE line, over 10M in length.

Operation sequence ① : Reset your tackle, and then press and hold the “Line Out / Autostop” Button for more than 3 seconds.

- * The reel will alarm, and the counter will be reset to 0.0. “OK” will be displayed at the top as shown in Picture 29

Picture 29

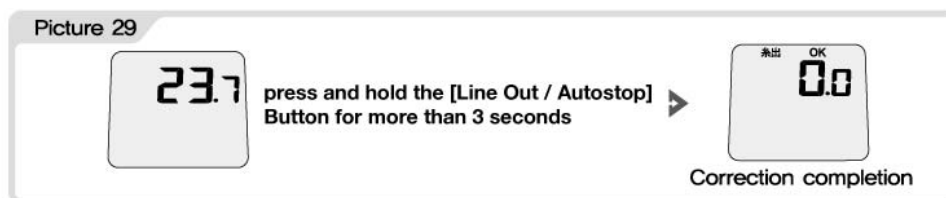

Attention

- ① The auto stop distance, and water surface settings will return to default. Auto stop default is 5M, water surface is set at 0M.

Safety Features

1 Battery Monitor

- The reel will monitor the battery voltage it is connected to.
- ❶ If the power supply is within the operational requirements, the battery icon should disappear 5 seconds after being plugged in.
- ❷ If the battery voltage is low, the battery icon will illuminate.
 - * Inspect connections, recharge, or replace battery.



- ❸ If the voltage exceeds the operational limits of the reel, an alarm will sound, and the image shown in the picture below will be displayed.



2 Auto stop speed reduction

- ❶ To avoid abrupt speed changes, the reel will slow the retrieval rate at 3M prior to the auto stop position.
- ❷ In high speed mode, the reel will have the first speed reduction at 10M, and then the second speed reduction at 3M from the auto stop position.

8

Safety Features

3 Memory back up

- If the power is disconnected from the reel, current data will be retained for approximately 10 minutes.



Attention

- ❗ Do not reel line, or release line while the power is removed from the reel. Personal injury, or tackle damage may occur.

4 Overload control

- If the motor becomes overloaded, the reel will protect the circuitry and stop spool rotation.
- Cycling the speed lever back to zero will allow a reset of the overload, returning to electric reeling.
- If the reel is overheated to a second stage, the speed lever will have no response for as long as 5 minutes, please let the reel cool down, and reel manually.



Attention

- Decrease the load on the reel if these faults occur.

5 Increased power mode

- If the reel is winding at a speed lower than maximum, and the spool stops for approximately 10 seconds, the power to the motor will be increased to maintain the winding speed.
- When increased power mode occurs, moving the speed lever will cause the reel to default to the lever indication speed.
- If the increased power mode cannot rotate the spool, the overheating protection may stop the motor. Let cool for 5 minutes before resuming.

9

Troubleshooting

Review prior to requesting repair

Problem	Possible Issues	Solutions
No display on the screen?	<ul style="list-style-type: none"> ● Power supply cord is not connected properly. ● Disconnection from the power supply ● Battery voltage is low 	<ul style="list-style-type: none"> ● Inspect connections and repair or clean as needed ● Charge battery, find another suitable battery
Depth measurement is not accurate or precise?	<ul style="list-style-type: none"> ● Error in line diameter setup ● Error due to line stretch 	<ul style="list-style-type: none"> ● Input fishing line again. ● Replace line
Automatic winding not working	<ul style="list-style-type: none"> ● Reel displaying 0.0 ● Weak battery ● Corrosion on the battery terminals. ● When using built in systems, voltage may be low, fuse / breaker may have tripped 	<ul style="list-style-type: none"> ● Reset line length ● Charge or change battery ● Clean terminals and inspect clamps. ● Inspect power supply, reset breaker, replace fuse.

If your problem persists after reviewing this guide, please contact the retailer where you purchased the reel for service and support.

10

Part list

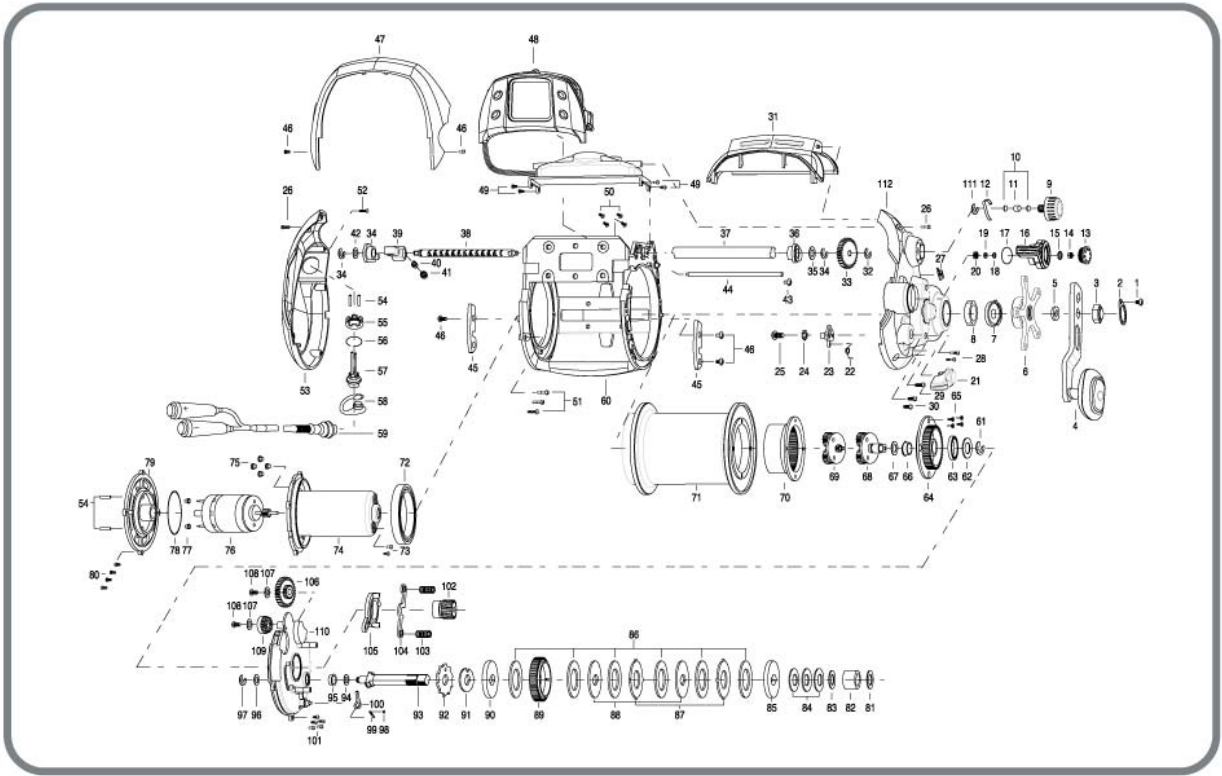

Key No.	Parts Name	Key No.	Parts Name	Key No.	Parts Name	Key No.	Parts Name
001	SCREW	032	RETAINER	063	BALL BEARING	094	WASHER
002	H/NUT PLATE	033	TRAVERSE GEAR	064	SPOOL COVER	095	BEARING
003	HANDLE NUT	034	RETAINER	065	SCREW	096	WASHER
004	HANDLE ASSY	035	WASHER	066	BEARING	097	RETAINER
005	WASHER	036	BUSH	067	WASHER	098	O-RING
006	STAR DRAG	037	PIPE	068	GEAR SHAFT ASSY	099	CLAW SPRING
007	CLICK HOLDER ASSY	038	WORM SHAFT	069	SUN GEAR ASSY	100	ANT CLAW
008	BUSH	039	LEVEL WIND ASSY	070	INTERNAL GEAR	101	SCREW
009	TENSION KNOB	040	LEVEL WIND PIN	071	SPOOL ASSY	102	PINION
010	WASHER	041	NUT CAP	072	BALL BEARING	103	COIL SPRING
011	WASHER	042	WASHER	073	SCREW	104	CLUTCH BAR
012	LEAF SPRING	043	SCREW	074	MOTOR BOX	105	CLUTCH CAM
013	LEVER CAP	044	SHAFT-A	075	PACKING-C	106	JOINT GEAR
014	NUT	045	GUARD PLATE	076	MOTOR ASSY	107	WASHER
015	TOOTH WASHER	046	SCREW	077	PACKING-B	108	SCREW
016	SPEED LEVER	047	FRONT COVER-A	078	O-RING-D	109	MAGNET ASSY
017	O-RING-C	048	CONTROL BOX ASSY	079	ONE WAY HOLDER ASSY	110	FRAME COVER ASSY
018	SPRING WASHER	049	SCREW	080	SCREW	111	RETAINER
019	WASHER	050	TAP SCREW	081	WASHER		
020	NUT	051	TAP SCREW	082	DRAG COLLAR		
021	CLUTCH LEVER	052	TAP SCREW	083	WASHER		
022	CAM SPRING	053	LEFT SIDE PLATE	084	DRAG SPRING		
023	CLUTCH LEVER CAM ASSY	054	TUBE	085	WASHER-D3		
024	TOOTH WASHER	055	NUT	086	WASHER		
025	SCREW	056	SPRING WASHER	087	WASHER-A		
026	SCREW	057	CONNECTOR ASSY	088	WASHER-D2		
027	LINE STOPPER	058	WATER CAP	089	DRIVE GEAR		
028	SCREW	059	CODE ASSY	090	WASHER-D1		
029	SCREW	060	FRAME ASSY	091	WASHER-D		
030	SCREW	061	RETAINER	092	RATCHET ASSY		
031	FRONT COVER	062	WASHER	093	GEAR METAL		

banax
www.banax.co.kr